

SCHEDULE "A"

N
CITY OF NANAIMO
PRELIMINARY LAYOUT
ACCEPTANCE

2020-NOV-05 *[Signature]*
 Date Approved By
 2021-NOV-05
 Expiry Date

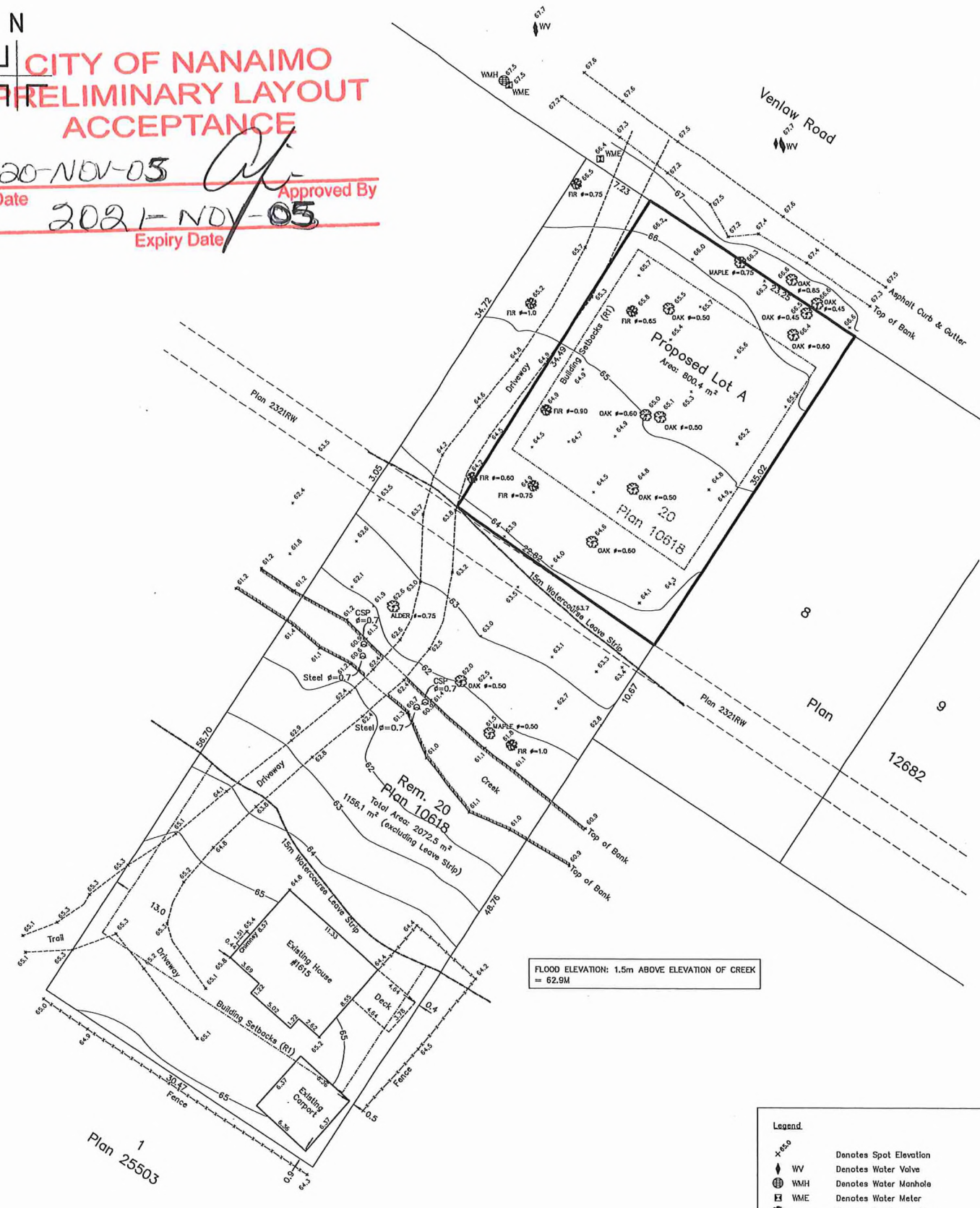

FLOOD ELEVATION: 1.5m ABOVE ELEVATION OF CREEK = 62.9M

- Legend**
- +88.0 Denotes Spot Elevation
 - WV Denotes Water Valve
 - WMH Denotes Water Manhole
 - WME Denotes Water Meter
 - (Tree Symbol) Denotes Coniferous Tree
 - (Tree Symbol) Denotes Deciduous Tree
 - (Circle with X) Denotes Culvert
 - φ Denotes Diameter

NOTE:
 THIS PROPERTY IS AFFECTED BY
 THE FOLLOWING REGISTERED DOCUMENT:
 M76301 (undersurface rights) & E362798 (Plan 2321RW).

SITE PLAN SHOWING PROPOSED SUBDIVISION OF:
 LOT 20, SECTION 13, RANGE 8,
 MOUNTAIN DISTRICT, PLAN 10618.

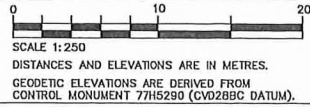

| DATE: | REVISION: |
|-----------------|------------------------------|
| March 2, 2020 | First Issue |
| March 10, 2020 | Notation for Flood Elevation |
| July 22, 2020 | Revise Lot Configuration |
| August 10, 2020 | Label "Top of Bank" at creek |

Turner & Associates
 Land Surveying
 250.753.9778
 435 Terminal Avenue North
 Nanaimo, BC V9S 4J8
 www.turnersurveys.ca

Client: BONNIE STEVENSON City Address: 1615 VENLAW ROAD, NANAIMO
 File: 18-115-20 Scale: 1:250 Drawn by: DRW Property Zoning: R1

30801391